

PROJECT : PROPOSED PLAN OF G+III STORIED (HT.- 12.495 M.) RESIDENTIAL BUILDING AT PREMISES NO.- 1C , JAHARLAL DUTT LANE, KOLKATA - 700 067, WARD NO - 13 , BOROUGH - III , P.S. - ULTADANGA, P.O. - ULTADANGA, UNDER KOLKATA MUNICIPAL CORPORATION.

Dated - 18.12.2020.

GPS 1
LATITUDE = 22d 35' 49.01"
LONGITUDE = 88d 23' 03.46"

GPS 2
LATITUDE = 22d 35' 48.90"
LONGITUDE = 88d 23' 03.65"

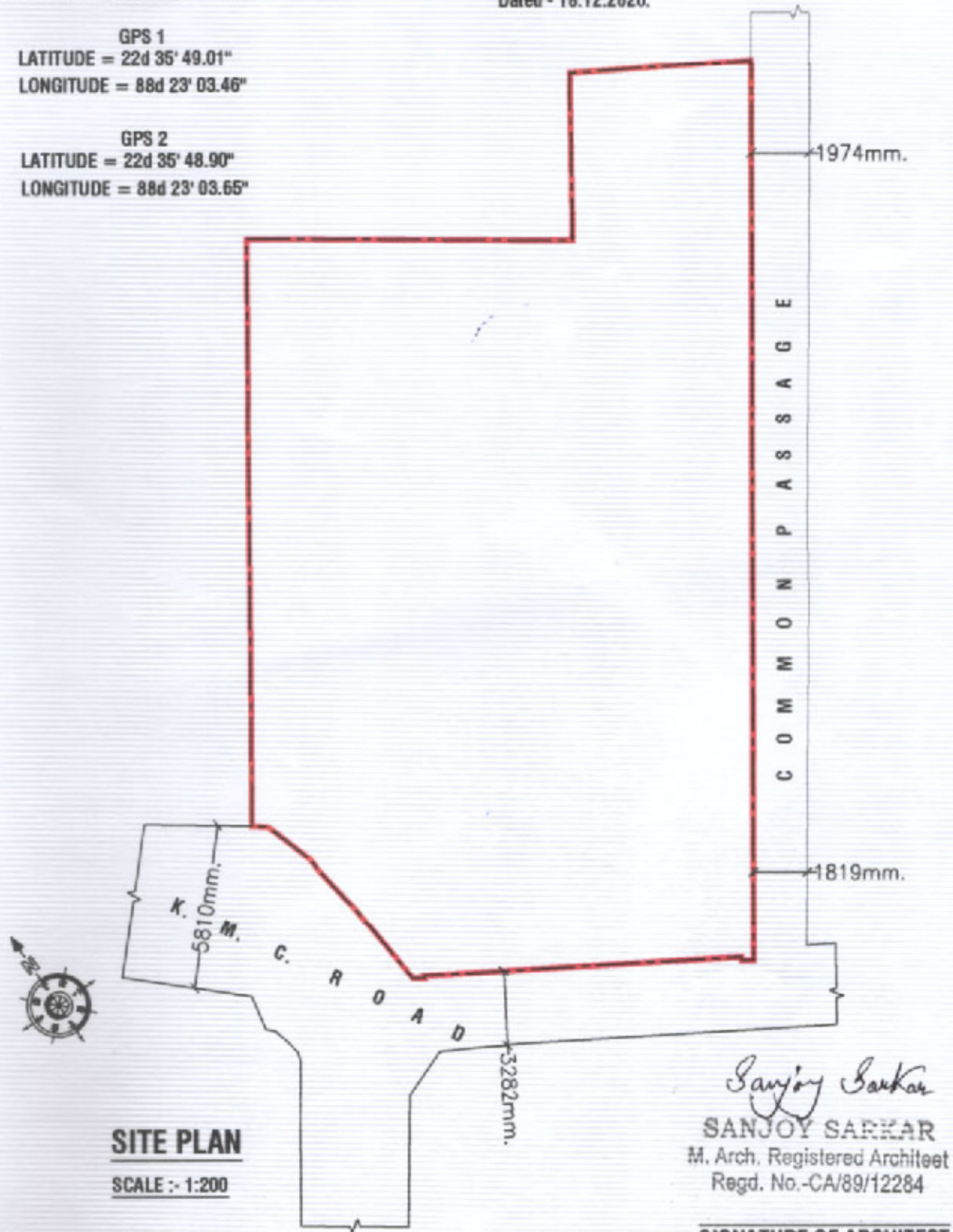

Sanjoy Sarkar
SANJOY SARKAR
M. Arch. Registered Architect
Regd. No.-CA/89/12284

SIGNATURE OF ARCHITECT